

Signal Towers, Beacons & Sounders



- Modular Stacking Light Towers
- Lamp, LED & Xenon Versions
- Light / Sound Combination Units
- Large Range of Sounders Including 

CONTENTS

Signal Towers Beacons & Sounders

Signal Towers	136
Signal Towers	137
Signal Tower Order Data	138
Warning Beacons	139
Xenon Flashing Beacons	140
Rotating & Blinking Beacons	141
Buzzers & Hooters	142
Other Auer Products	143





SIGNAL TOWERS



- Bayonet fitting modules for easy assembly
- Steady light, blinking or flashing modules
- Buzzer/light combination module
- Multi-tone sound generator options
- Up to 5 modules/tower
- Choice of 6 different colours (3 for LED types)

GENERAL DESCRIPTION

The J Auer warning tower offers an optical and acoustic signalling system of modular construction. Up to five modules can be fitted into the stack with up to six different colours (red, green, orange, yellow, blue and clear) in either steady light, blinking or flashing. A multi-tone sound generator or sound/light combination is possible in the top position, as well as a simple buzzer module. All wiring is connected to the finger proof terminals in the base which can be surface, pole or wall mounted.

The modules are then simply bayonet fitted onto each other without the need for tools and no live terminals are exposed. This makes assembly and disassembly for lamp replacement quick, easy and safe.

For longer life or high vibration applications LED versions are available with steady light, blinking and rotating functions (red, green and orange only). Protection is IP65 as standard. Available voltages are 12Vac/dc, 24Vac/dc, 110Vac and 230Vac.

TECHNICAL DATA

Housing and lens material:	Polycarbonate
Maximum wire size:	2.5mm ²
Temperature range:	-20 to +70°C
IP rating:	IP65 standard, IP53 for sound generators and combi-modules
Voltages available:	12Vac/dc ; 24Vac/dc ; 115Vac ; 230Vac
Voltage supply tolerance:	+/- 10%
Approvals:	UL, cUL, CE marked (EMC and LVD)
Lamp type:	BA15d

TYPES OF MODULES

Light Modules

SLL	Warning Light Module	
SLB	Blinking Light Module	
SLF	Flashing Light Module	
SDC	LED-Warning Light Module	
SDA	LED-Blinking Light Module	
SDR	LED-Warning Light Module, rotating	

Light-Buzzer Combo Modules

SLP	Warning Light-Buzzer Combo Module	
SBP	Blinking Light-Buzzer Combo Module	
SFP	Flashing Light-Buzzer Combo Module	
SCP	LED-Warning Light-Buzzer Combo Module	
SAP	LED-Blinking Light-Buzzer Combo Module	
SRP	LED-Warning Light-Buzzer Combo Module, rotating	

Sound Generator Modules

STE	Sound Generator Module (Single tone)	
STZ	Sound Generator Module (Dual tone)	

Buzzer Modules

SPE	Buzzer Module (Continuous or selectable pulsing switchable)
SPZ	Buzzer Module (Continuous or pulsing externally selectable)

Basic Module, for horizontal mounting

assembled, consisting of:

- Cap
- Basic Module, for horizontal mounting
- Flat gasket, for surface mounting



Basic Module, for vertical mounting

assembled, consisting of:

- Cap
- Basic Module, for horizontal mounting
- Bracket
- Flat gasket, for bracket surface mounting

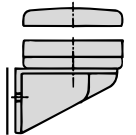

Basic Module Sub-Assembly, Tube 10cm

assembled, consisting of:

- Cap
- Basic Module, for tube mounting
- Tube with pole base, tubes available in 10cm, 25cm, 40cm, 50cm, 60cm & 80cm lengths
- Flat gasket, for pole base

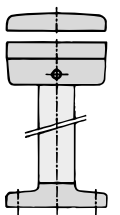

POSSIBLE COMBINATIONS OF MODULES

Warning light tower (optical signals only)

1 to 5 light modules (SLL, SLB, SLF, SDC, SDA or SDR) in any combination.

Warning tower with buzzer (optical and acoustical signals)

1 to 4 light modules (SLL, SLB, SLF, SDC, SDA or SDR) in any combination + 1 light/buzzer combo module (SLP, SBP, SFP, SCP, SAP, or SRP) on top of stack only.

Warning tower with sound generator or buzzer (optical and acoustical signals)

1 to 4 light modules (SLL, SLB, SLF, SDC, SDA or SDR) in any combination + 1 single tone sound generator module (STE) or SPE buzzer module on top of stack only.

Warning tower with dual tonesound generator or buzzer (optical and acoustical signals)

1 to 3 light modules (SLL, SLB, SLF, SDC, SDA or SDR) in any combination + 1 dual tone sound generator module (STZ) or SPZ buzzer module on top of stack only.

DIMENSIONS

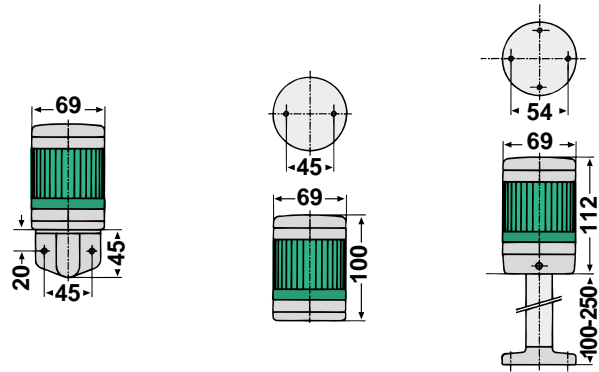

Dimensions shown are for single light module towers

- for each extra light module of any type add 68mm to height shown
- for a sound generator module (STE or STZ) add 68mm to height shown
- for a light buzzer combo module add 100mm to height shown

TECHNICAL DETAILS

SLL Warning Light Module	
Bulb:	max. 7 W
Socket:	BA 15d
SLB Blinking Light Module	
Bulb:	max. 7W
Socket:	BA 15d
Blinking frequency:	approx. 1.5 - 2 Hz
SLF Flashing Light Module	
Flash energy:	3 Joule
Flash frequency:	approx. 1.5 - 2 Hz
SDC LED - Warning Light Module	
Light:	maintenance free LED's
Light design:	SMD-LED (surface mounted)
Light emission:	360°
Lighting:	continuous light
SDA LED - Blinking Light Module	
Light:	maintenance free LED's
Light design:	SMD-LED (surface mounted)
Light emission:	360°
Lighting:	blinking light
Blinking frequency:	approx. 1.5 Hz
SDR LED - Warning Light Module, rotating	
Light:	maintenance free LED's
Light design:	SMD-LED (surface mounted)
Light emission:	360°
Lighting:	rotating light
SLP Warning Light-Buzzer Combo Module	
Bulb:	max. 7 W
Socket:	BA 15d
Type of sound:	continuous or pulsing tone (switchable)
Tone frequency:	2400 Hz
Sound level:	92 dB(A) in 1m
Sound level:	92 dB(A) in 1m
SBP Blinking Light-Buzzer Combo Module	
Bulb:	max. 7 W
Socket:	BA 15d
Type of sound:	continuous or pulsing tone (switchable)
Tone frequency:	2400 Hz
Sound level:	92 dB(A) in 1m
Sound level:	92 dB(A) in 1m
SFP Flashing Light-Buzzer Combo Module	
Flash energy:	3 Joule
Flash frequency:	approx. 1.5 - 2 Hz
Type of sound:	continuous or pulsing tone (switchable)
Tone frequency:	2400 Hz
Sound level:	92 dB(A) in 1 m

SCP LED-Warning Light-Buzzer Combo Module	
Light:	maintenance free LED's
Light design:	SMD-LED (surface mounted)
Light emission:	360°
Lighting:	continuous light
Type of sound:	continuous or pulsing tone (switchable)
Tone frequency:	2400 Hz
Sound level:	92 dB(A) in 1 m
SAP LED-Blinking Light-Buzzer-Combo-Module	
Light:	maintenance free LED's
Light design:	SMD-LED (surface mounted)
Light emission:	360°
Lighting:	blinking light
Blinking frequency:	approx. 1.5 Hz
Type of sound:	continuous or pulsing tone (switchable)
Tone frequency:	2400 Hz
Sound level:	92 dB(A) in 1 m
SRP LED-Warning Light-Buzzer Combo Module, rotating	
Light:	maintenance free LED's
Light design:	SMD-LED (surface mounted)
Light emission:	360°
Lighting:	rotating light
Type of sound:	continuous or pulsing tone (switchable)
Tone frequency:	2400 Hz
Sound level:	92 dB(A) in 1 m
STE/STZ Sound Generator	
Type of sound:	15 various tones, see sound chart
Sound level:	85 - 103 dB(A) in 1 m, see sound chart
Volume:	adjustable by means of a potentiometer
Speed:	adjustable by means of a potentiometer
Upper tone frequency:	adjustable by means of a potentiometer
Lower tone frequency:	adjustable by means of a potentiometer
STE (Single tone):	set to one sound
STZ (Dual tone):	set to one sound combination (2 tones)
Sound setting:	by means of a DIP switch
SPE/SPZ Buzzer Module	
Type of sound:	Continuous or pulsing
Tone frequency:	2400Hz
Sound level:	92dB(A) in 1 m

ORDER DATA

Type	Order No.	Flash energy (J)	Nominal voltage (V)	Bulb max. (W)
SLL/Warning Light Module	210 50 x 900		250 V \neq (AC/DC)	7
SLB/Blinking Light Module	220 50x 404 220 50x 405 220 50x 310 220 50x 313		12 V \neq (AC/DC) 24 V \neq (AC/DC) 110/120 V \approx (AC) 230/240 V \approx (AC)	7 7 7 7
Type	Order No.	Flash energy (j)	Nominal voltage (V)	Nominal current (mA)
SLF/Flashing Light Module	230 50x 404 230 50x 405 230 50x 310 230 50x 313	3 3 3 3	12 V \neq (AC/DC) 24 V \neq (AC/DC) 110/120 V \approx (AC) 230/240 V \approx (AC)	240 170 50 35
SDC/LED-Warning Light Module	211 50x 404 211 50x 405 211 50x 310 211 50x 313		12 V \neq (AC/DC) 24 V \neq (AC/DC) 110/120 V \approx (AC) 230/240 V \approx (AC)	80 80 80 80
SDA/LED-Blinking Light Module	221 50x 404 221 50x 405 221 50x 310 221 50x 313		12 V \neq (AC/DC) 24 V \neq (AC/DC) 110/120 V \approx (AC) 230/240 V \approx (AC)	80 80 80 80
SDR/LED-Warning Light Module, rotating	231 50x 404 231 50x 405 231 50x 310 231 50x 313		12 V \neq (AC/DC) 24 V \neq (AC/DC) 110/120 V \approx (AC) 230/240 V \approx (AC)	80 80 80 80
Type	Order No.	Flash energy (j)	Nominal voltage (V)	Bulb max. (W)
SLP/Warning Light-Buzzer Combo Module	250 50x 404 250 50x 405 250 50x 310 250 50x 313		12 V \neq (AC/DC) 24 V \neq (AC/DC) 110/120 V \approx (AC) 230/240 V \approx (AC)	7 7 7 7
SBP/Blinking Light-Buzzer Combo Module	260 50x 404 260 50x 405 260 50x 310 260 50x 313		12 V \neq (AC/DC) 24 V \neq (AC/DC) 110/120 V \approx (AC) 230/240 V \approx (AC)	7 7 7 7

Type	Order No.	Flash energy (j)	Nominal voltage (V)	Nominal current (mA)
SFP/Flashing Light-Buzzer Combo Module	270 50x 404 270 50x 405 270 50x 310 270 50x 313	3 3 3 3	12 V \neq (AC/DC) 24 V \neq (AC/DC) 110/120 V \approx (AC) 230/240 V \approx (AC)	250 180 70 55
SCP/LED-Warning Light-Buzzer Combo Module	251 50x 404 251 50x 405 251 50x 310 251 50x 313		12 V \neq (AC/DC) 24 V \neq (AC/DC) 110/120 V \approx (AC) 230/240 V \approx (AC)	90 90 100 100
SAP/LED-Blinking Light-Buzzer Combo Module	261 50x 404 261 50x 405 261 50x 310 261 50x 313		12 V \neq (AC/DC) 24 V \neq (AC/DC) 110/120 V \approx (AC) 230/240 V \approx (AC)	90 90 100 100
SRP/LED-Warning Light-Buzzer Combo Module	271 50x 404 271 50x 405 271 50x 310 271 50x 313		12 V \neq (AC/DC) 24 V \neq (AC/DC) 110/120 V \approx (AC) 230/240 V \approx (AC)	90 90 100 100
Type	Order No.	Type of sound	Nominal voltage (V)	Nominal current (mA)
STE/Sound Generator Module (Single tone)	241 500 404 241 500 405 241 500 310 241 500 313	as per sound chart	12 V \neq (AC/DC) 24 V \neq (AC/DC) 110/120 V \approx (AC) 230/240 V \approx (AC)	30 65 60 60
STZ/Sound Generator Module (Dual tone)	242 500 404 242 500 405 242 500 310 242 500 313	as per sound chart	12 V \neq (AC/DC) 24 V \neq (AC/DC) 110/120 V \approx (AC) 230/240 V \approx (AC)	30 65 60 60
Basic Modules	Order No.	Description		
BMW	200 500 900	Basic Module, for horizontal mounting		
BMV	200 600 900	Basic Module + Bracket for vertical mounting		
BMR1	200 700 900	Tube-Basic Module Sub-Assembly 10cm		
BMR2	200 800 900	Tube-Basic Module Sub-Assembly 25cm		

Colour Code for Lens (insert code in place of 'x' in the required part number)
 Colour code 1 = orange, 2 = red, 4 = clear, 5 = blue, 6 = green, 7 = yellow
 Colour code for LED-Modules : 1 = orange, 2 = red, 6 = green

ACCESSORIES

Type	Order No.	Description
GL12	890 010 904	Bulb 12 V - 7 W
GL24	890 010 905	Bulb 24 V - 7 W
GL48	890 010 908	Bulb 48 V - 7 W
GL60	890 010 909	Bulb 60 V - 7 W
GL11	890 010 910	Bulb 110/120 V - 7 W
GL23	890 010 913	Bulb 230/240 V - 7 W
DI 1	204 0E0 003	IP 65 Set of lens sealing gaskets (6 O-rings)
DI 2	204 0E0 004	Set of gaskets for all types of mounting (3 Flat gaskets)
DI 3	204 0E0 005	IP 65 Set of lens sealing gaskets (3 O-rings)

GENERAL DESCRIPTION

SPE - Buzzer Module		
		Nominal current (mA)
243 500 404	12Vac/dc	10
243 500 405	24Vac/dc	20
243 500 310	110/120Vac	20
243 500 313	230/240Vac	20
SPZ - Buzzer Module		
244 500 404	12Vac/dc	10
244 500 405	24Vac/dc	20
244 500 310	110/120Vac	20
244 500 313	230/240Vac	20

ELECTRICAL CONNECTION

Wiring
 Wiring schematic instructions:

- 0 ... common connection
- 1 ... Module 1
- 2 ... Module 2
- 3 ... Module 3
- 4 ... Module 4
- 5 ... Module 5

All modules are wired via the Basic-Module

- Wire modules always to terminals (n) corresponding to mounting position (n) or module

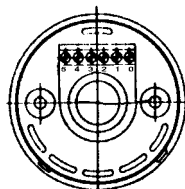

SOUND CHART STE-STZ

STE	Speed	Upper Frequency	Lower Frequency	Volume	Symbol	STZ	STZ
Tone						Tone 1	Tone 2
Triangle Tone	7-22 Hz	1500 Hz	500 Hz	80-100 dB(A)		Triangle Tone	Continuous Tone
Continuous Tone	-	500-1500Hz	max.	83-103 dB(A)		Continuous Tone	Changing Tone
Continuous Tone	-	max.	500-1500 Hz	83-103 dB(A)		Continuous Tone	Interrupted Tone
Interrupted Tone	0.5-1.5 Hz	500-1500 Hz	max.	83-103 dB(A)		Interrupted Tone	Three Tone Gong
Interrupted Tone	0.5-1.5 Hz	max.	500-1500 Hz	83-103 dB(A)		Interrupted Tone	Siren (non-repeating)
Changing Tone	0.5-1.5 Hz	500-1500 Hz	500-1500 Hz	83-103 dB(A)		Changing Tone	DIN Emergency Signal
Saw Tooth Tone ascending	0.5-1.5 Hz	500-1500 Hz	500-1500 Hz	83-103 dB(A)		Saw Tooth Tone ascending	Continuous Tone
Saw Tooth Tone descending	0.5-1.5 Hz	500-1500 Hz	500-1500 Hz	83-103 dB(A)		Saw Tooth Tone descending	Interrupted Tone
Sine Wave Tone	0.5-1.5 Hz	500-1500 Hz	500-1500 Hz	82-102 dB(A)		Sine Wave Tone	DIN Emergency Signal
DIN Emergency Signal	1 Hz	1200 Hz	500 Hz	82-102 dB(A)		DIN Emergency Signal	Three Tone Gong (non-repeating)
Siren (non-repeating)	2-4s	1500 Hz	500 Hz	83-103 dB(A)		Siren (non-repeating)	Triangle Tone
Signal Horn (Continuous Tone)	-	max.	100-350 Hz	64-80 dB(A)		Signal Horn (Continuous Tone)	Continuous Tone
Three Tone Gong	2-4 s	660 Hz	550 Hz 440Hz	76-95 dB(A)		Three Tone Gong	Sine Wave Tone
Two Tone Gong	2-3 s	550 Hz	440 Hz	75-93 dB(A)		Two Tone Gong	Two Tone Gong (non-repeating)
Gong	1-3 s	max.	500-1500 Hz	75-93 dB(A)		Gong	Continuous Tone



WLG WARNING BEACON



- large steady light beacon
- IP65 protection
- 6 lens colours possible
- up to 25W lamp can be used
- bayonet fitting of lens for easy bulb change

TECHNICAL DESCRIPTION

Housing:	ABS, grey or black	Terminals:	up to 2.5 mm ²	Duty cycle factor:	100%
Cap:	Polycarbonate	Fixing:	horizontal or vertical	Bulb:	max. 25 W
Cap colour:	orange, red, clear, blue, green, yellow	Range of temperature:	-20 to +60 °C	Socket:	BA 15d
				Protecting class:	IP 65 acc. to IEC 529

PART NOS. (BLACK ABS HOUSING)

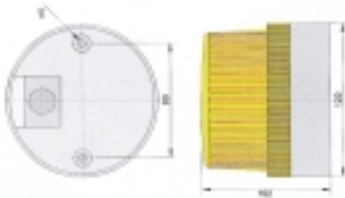

822 50x 900	up to 250Vac/dc (max. 25W bulb)	890 025 908	48V, 25W bulb
890 025 904	12V, 25W bulb	890 025 909	60V, 25W bulb
890 025 905	24V, 25W bulb	890 025 910	110V, 25W bulb
		890 025 913	230V, 25W bulb

x Lens colour code
 1 = orange; 2 = red; 4 = clear; 5 = blue; 6 = green; 7 = yellow
 N.B Grey housings are available as an option. Please enquire.



WLK WARNING BEACON



- small steady light beacon
- IP54 protection (IP65 option)
- 6 lens colour possible
- horizontal, vertical or pole mount
- bayonet fitting of lens for easy bulb change

TECHNICAL DESCRIPTION

Housing:	ABS, grey or black	Cable entry:	6.5 to 12mm	Duty cycle factor:	100%
Cap:	Polycarbonate	Fixing:	horizontal, vertical or tube	Bulb:	max. 10 W
Cap colour:	orange, red, clear, blue, green, yellow	Range of temperature:	-20 to +50 °C	Socket:	BA 15d
Terminals:	up to 2.5 mm ²			Protecting class:	IP 54 acc. to IEC 529 IP 65 with additional sealing

PART NOS. (BLACK ABS HOUSING)

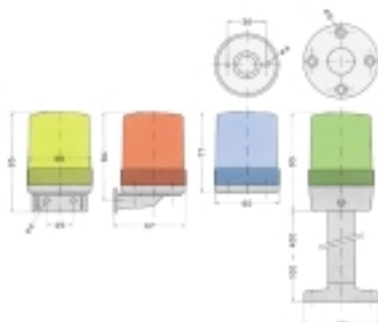

820 11x 425	horizontal fixing
820 12x 425	vertical fixing
820 13x 425	base for tube fixing
891 110 925	10 cm tube assembly
891 125 925	25 cm tube assembly
820 0E0 003	sealing for IP65
890 010 904	12V, 7W bulb
890 010 905	24V, 7W bulb
890 010 910	110V, 7W bulb
890 010 913	230V, 7W bulb

x Lens colour code
 1 = orange; 2 = red; 4 = clear; 5 = blue; 6 = green; 7 = yellow
 N.B Grey housings are available as an option. Please enquire.

XENON FLASHING BEACONS



FLG (120MM DIA)



- 10 Joule flash energy
- IP65 protection
- 6 lens colours possible
- for indoors or outdoors

TECHNICAL DESCRIPTION

Housing:	ABS, grey or black
Cap:	Polycarbonate
Cap colour:	orange, red, clear, blue, green, yellow
Terminals:	up to 2.5mm ²
Cable conduit:	surface or buried
Service life:	1600h at 10 Joule
Fixing:	horizontal or vertical
Range of temperature:	-20 to +50 °C
Duty cycle factor:	100%
Flash energy:	10 Joule
Flash frequency:	approx. 1 Hz
Protecting class:	IP 65 acc. to IEC 529
Special voltages:	on request



PART NO (BLACK ABS HOUSING)

842 54x 004	10 Joule, 12Vdc
842 54x 005	10 Joule, 24Vdc
842 53x 310	10 Joule, 110Vac (50/60Hz)
842 53x 313	10 Joule, 230Vac (50/60Hz)
2 flash frequencies (10 Joule)	
842 56x 005	30/60 flash/min 24Vdc
842 57x 005	30/90 flash/min 24Vdc

x Lens colour code
1 = orange; 2 = red; 4 = clear; 5 = blue; 6 = green; 7 = yellow



BZG (72MM DIA)



- 5 or 15 Joule flash energy
- IP65 protection
- 7 lens colours possible
- for indoors or outdoors
- corrosion resistant housing

TECHNICAL DESCRIPTION

Housing:	Aluminium die casting, seawater-proof, epoxy powder-coated
Cap:	Polycarbonate
Cap colours:	orange, red, white, clear, blue, green, yellow
Terminals:	up to 2.5mm ²
Cable entry:	PG11
Cable conduit:	surface or buried
Service life:	2000h at 5 Joule 1300h at 15 Joule
Range of temperature:	-20 to +50 °C
Duty cycle factor:	100%
Flash energy:	5 Joule, 15 Joule
Flash frequency:	approx. 1 Hz
Protecting class:	IP 65 acc. to IEC 529
Special voltage:	on request

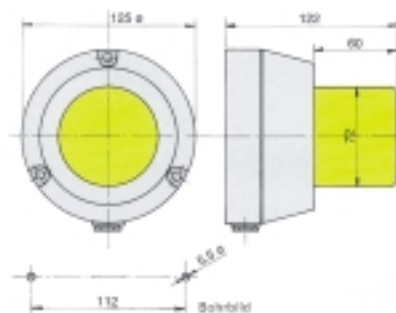

PART NO (GREY DIE-CAST HOUSING)

741 01x 404	5 Joule, 12Vac/dc
741 01x 405	5 Joule, 24Vac/dc
741 01x 110	5 Joule, 110Vac (50/60Hz)
741 01x 113	5 Joule, 230Vac (50/60Hz)
741 02x 004	5 Joule, 12Vdc
741 02x 005	5 Joule, 24Vdc
741 04x 004	15 Joule, 12Vdc
741 04x 005	15 Joule, 24Vdc
741 03x 110	15 Joule, 110Vac (50/60Hz)
741 03x 113	15 Joule, 230Vac (50/60Hz)

x Lens colour code
1 = orange; 2 = red; 3 = white 4 = clear; 5 = blue; 6 = green; 7 = yellow



BZL (76MM DIA)



- 5 or 15 Joule flash energy
- IP53 protection
- 7 lens colours possible
- for indoors

TECHNICAL DESCRIPTION

Housing:	ABS, grey
Cap:	Polycarbonate
Cap colours:	orange, red, white, clear, blue, green, yellow
Terminals:	up to 1.5mm ²
Cable entry:	rubber gland from 6,5 to 15mm diameter
Cable conduit:	surface or buried
Service life:	2000h at 5 Joule 1300h at 15 Joule
Range of temperature:	-20 to +50 °C
Duty cycle factor:	100%
Flash energy:	5 Joule, 15 Joule
Flash frequency:	approx. 1 Hz
Protecting class:	IP 53 acc. to IEC 529
Special voltage:	on request

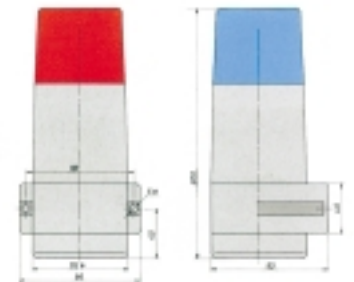

PART NO (GREY ABS HOUSING)

740 01x 404	5 Joule, 12Vac/dc
740 01x 405	5 Joule, 24Vac/dc
740 01x 110	5 Joule, 110Vac (50/60Hz)
740 01x 113	5 Joule, 230Vac (50/60Hz)
740 02x 004	5 Joule, 12Vdc
740 02x 005	5 Joule, 24Vdc
740 04x 004	15 Joule, 12Vdc
740 04x 005	15 Joule, 24Vdc
740 03x 110	15 Joule, 110Vac (50/60Hz)
740 03x 113	15 Joule, 230Vac (50/60Hz)

N.B. Twin flash frequency versions available please enquire

x Lens colour code
1 = orange; 2 = red; 3 = white (BZG&BZL only); 4 = clear; 5 = blue; 6 = green; 7 = yellow
N.B Grey housings are available as an option. Please enquire.



880/881 ROTATING MIRROR BEACONS



- high intensity rotating mirror
- IP54 protection
- 5 lens colours possible
- halogen lamp or E14 bulb versions

TECHNICAL DESCRIPTION

Housing:	Thermoplastic with injected metal base	Mirror rotation speed:	170 rpm
Cap:	Plexiglas	Range of temperature:	-20 to +50 °C
Cap colour:	orange, red, clear, blue, green	Radio noise suppression:	acc. to CENELEC EN 55014
Terminals:	up to 2.5mm ²	Dutycycle factor:	100%
Mounting:	horizontal, vertical or flange for tube fixing	Protection class:	IP54 acc. to IEC 529

PART NOS.

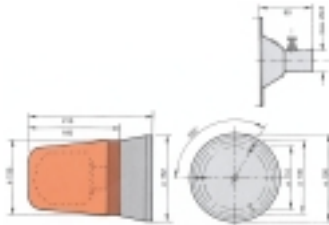

988 0x5 254	12Vdc (Halogen version)
988 0x5 255	24Vdc (Halogen version)
988 0x5 268	230Vac (Halogen version)
989 0x5 268	230Vac (E14 bulb version)
985 588 034	12V, 55W spare halogen lamp
985 588 035	24V, 70W spare halogen lamp
988 000 000	holder for tube

x Lens colour code
1 = orange; 2 = red; 4 = clear; 5 = blue; 6 = green



BKG BLINKING BEACONS



- Blinking
- IP65 protection
- 6 lens colours
- 25w lamp
- Tough polycarbonate lens

TECHNICAL DESCRIPTION

Housing:	ABS, grey or black	Range of temperature:	-20 to +60 °C
Cap:	Polycarbonate	Dutycycle factor:	100%
Cap colour:	orange, red, clear, blue, green, yellow	Lamp:	max. 25w, BA15d
Terminals:	up to 2.5mm ²	Blinking frequency:	approx. 1HZ
Mounting:	horizontal or vertical	Protection class:	IP65 acc. to IEC 529

PART NOS. (BLACK ABS HOUSING)

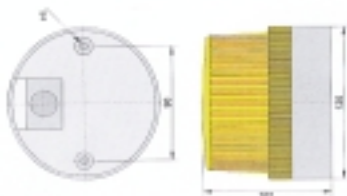

832 50x 404	12Vac/dc
832 50x 405	24Vac/dc
832 50x 310	110Vac
832 50x 313	230Vac
890 025 904	12V, 25W bulb
890 025 905	24V, 25W bulb
890 025 908	48V, 25W bulb
890 025 909	60V, 25W bulb
890 025 910	110V, 25W bulb
890 025 913	230V, 25W bulb

x Lens colour code
1 = orange; 2 = red; 4 = clear; 5 = blue; 6 = green; 7 = yellow
N.B Grey housings are available for BKG as an option. Please enquire.

BUZZERS & HOOTERS



KLH/KDH



- low cost mini-hooter
- with or without horn
- 92dB(dc) 88dB(ac)
- in grey ABS



HPT



- signal horn
- IP55 protection
- 108dB
- in grey ABS



ESD/ESP



- piezo buzzer for 28mm hole
- wide voltage range
- low current consumption
- 98dB

TECHNICAL DESCRIPTION

Housing:	ABS, grey
Terminals:	up to 2.5mm ²
Cable entry:	6.5 to 15mm
Cable conduit:	surface or buried
Test voltage:	2000V = coil against ground
Mounting:	Sound outlet downwards
Range of temperature:	-20 to +50 °C
Radio noise suppression:	acc. to CENELEC EN 55014
Duty cycle factor:	100%
Weight:	KLH: 160g, KDH: 140g
Sound pressure level:	AC: 88 dB(A) in 1m DC: 92 dB(A) in 1m
Protection class:	IP32 acc. to IEC 529
Special version:	on request

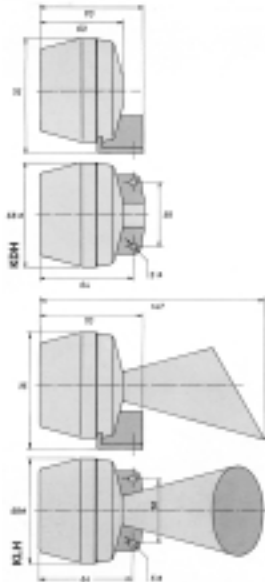

TECHNICAL DESCRIPTION

Housing:	ABS, grey, weatherproof
Terminals:	up to 2.5mm ²
Cable entry:	6.5 to 12mm
Cable conduit:	surface or buried
Test voltage:	2000 V = coil against ground
Mounting:	Sound outlet downwards
Range of temperature:	-20 to +50 °C
Radio noise suppression:	acc. to CENELEC EN 55014
Duty cycle factor:	100%
Weight:	1.1 kg
Sound pressure level:	approx. 108 dB(A) in 1m
Protecting class:	IP55 acc. to IEC 529
Relay type:	HPTR - with integrated telephone-call current relay

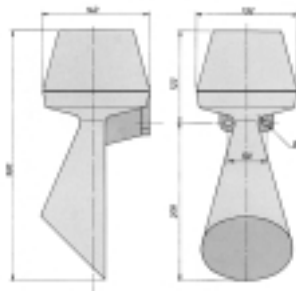

TECHNICAL DESCRIPTION

Housing:	Thermoplastic (ABS)
Terminals:	Spades 6.3 x 0.8
Types of sound:	continuous or pulsating tone
Sound frequency:	2400 Hz
Fixing:	Central for hole 28 mm
Range of temperature:	-20 to +70 °C
Duty cycle factor:	100%
Weight:	55g
Sound pressure level:	98 dB(A) in 1m
Protection class:	IP21 acc. to DIN 40050 IP54 according to installation

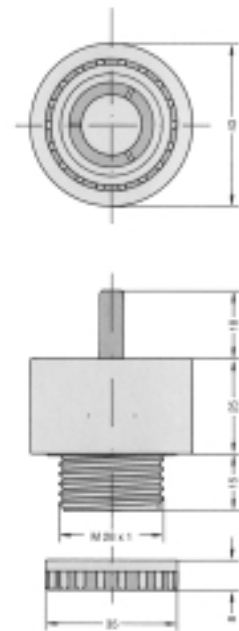

PART NO (GREY ABS HOUSING)

KLH	KDH	
710 100 105	710 000 105	(24Vac)
710 100 108	710 000 108	(48Vac)
710 100 110	710 000 110	(110Vac)
710 100 113	710 000 113	(230Vac)
710 100 004	710 000 004	(12Vdc)
710 100 005	710 000 005	(24Vdc)

Other voltages are available. Please enquire.

PART NO (GREY ABS HOUSING)

HPT	
712 100 105	(24Vac)
712 100 108	(48Vac)
712 100 110	(110Vac)
712 100 113	(230Vac)
712 100 004	(12Vdc)
712 100 005	(24Vdc)

Other voltages are available. Please enquire.

PART NO (BLACK ABS HOUSING)

ESD (continuous tone)		
810 000 405	24Vac/dc	(4-40V)
810 000 113	230Vac	(30-250V)
ESP (pulsating tone)		
811 000 405	24Vac/dc	(4-40V)
811 000 113	230Vac	(30-250V)

Also available in grey ABS

OTHER PRODUCTS IN THE J AUER RANGE

INDOOR/INSERT HOOTER IPT/EPT



- Hooter for indoor or panel mount applications
- 107/105dB(A) in 1m
- Voltage ranges from 6-230Vac/dc
- Mesh guarded

INDUSTRIAL HOOTER HTG

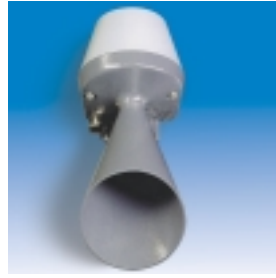

- Robust aluminium die cast hooter
- Special Teflon coated version for ships
- Integrated telephone call current relay
- 108dB(A) in 1m
- IP55 standard (IP67 option)

BELL UWS/FWS



- Dome alarm bell
- Indoor and outdoor use
- IP54
- 105dB(A) in 1m

ELECTRONIC SOUND GENERATOR EHG/EHL



- Very loud sound generator
- Indoor and outdoor use
- 118dB(A) in 1m
- IP65
- Continuous or wailing tone selectable

MOTOR SIREN SE1, SE2, SE3



- Motor driven sirens for large warning areas
- Upto 120dB(A) in 1m
- Aluminium die cast enclosure
- IP44

'EX' SIGNAL BELL DWG/DWGR



- Explosion proof loud signal alarm for hazardous areas
- Optional telephone call relay
- 107dB(A) in 1m
- IP54

'EX' HORN DHG/DHGR



- Explosion proof signal horn for hazardous areas
- Grey casting epoxy powder coated
- 107dB(A) in 1m
- IP54

'EX' FLASHING BEACON DBZ



- Explosion proof flashing beacon for hazardous areas
- Grey casting with moulded glass dome
- 7 glass colours available
- 5 or 15 joule xenon lamp
- IP65

'EX' ROTATING BEACON DR2



- Explosion proof rotating beacon for hazardous areas
- Grey casting with moulded glass dome
- 4 glass colours available
- 55w Halogen lamp
- IP65

'EX' WALL TELEPHONE DWTG



- Explosion proof wall mounted telephone
- Epoxy coated cast aluminium casing
- All bare metal parts are stainless quality A4
- Impulse on multi-frequency dialing
- IP55

Please enquire for details

Tel 0131 448 2828 Fax 0131 448 2880
e-mail: sales@lpc-uk.com



The Panel Products Catalogue



**2001
PRICE
LISTS**

1. Control & Signalling
2. Camswitches
3. Switch Disconnectors
4. Residual Current Circuit Breakers
5. Relays
6. Timers
7. Control Relays
8. Counters
9. Solid State Relays
10. Solid State Interface Relays
11. Signal Towers, Beacons & Sounders
12. Footswitches

**Automation & Control
Specialists**

and a whole lot more!

AUER

Price List 2001

Warning Tower modul SIGNAL

SLL Warning light module

250Vac/dc	210 10* 900	Grey	£ 14.27
250Vac/dc	210 50* 900	Black	£ 14.27

SLB Blinking light module

12Vac/dc	220 10* 404	Grey	£ 29.76
12Vac/dc	220 50* 404	Black	£ 29.76
24Vac/dc	220 10* 405	Grey	£ 29.76
24Vac/dc	220 50* 405	Black	£ 29.76
110/120Vac	220 10* 310	Grey	£ 31.80
110/120Vac	220 50* 310	Black	£ 31.80
230/240Vac	220 10* 313	Grey	£ 31.80
230/240Vac	220 50* 313	Black	£ 31.80

SLF Flashing light module

12Vac/dc	230 10* 404	Grey	£ 54.02
12Vac/dc	230 50* 404	Black	£ 54.02
24Vac/dc	230 10* 405	Grey	£ 54.02
24Vac/dc	230 50* 405	Black	£ 54.02
110/120Vac	230 10* 310	Grey	£ 42.40
110/120Vac	230 50* 310	Black	£ 42.40
230/240Vac	230 10* 313	Grey	£ 42.40
230/240Vac	230 50* 313	Black	£ 42.40

SDC LED Warning light module

12Vac/dc	211 10* 404	Grey	£ 55.14
12Vac/dc	211 50* 404	Black	£ 55.14
24Vac/dc	211 10* 405	Grey	£ 55.14
24Vac/dc	211 50* 405	Black	£ 55.14
110/120Vac	211 10* 310	Grey	£ 56.26
110/120Vac	211 50* 310	Black	£ 56.26
230/240Vac	211 10* 313	Grey	£ 56.26
230/240Vac	211 50* 313	Black	£ 56.26

SDA LED Blinking light module

12Vac/dc	221 10* 404	Grey	£ 56.26
12Vac/dc	221 50* 404	Black	£ 56.26
24Vac/dc	221 10* 405	Grey	£ 56.26
24Vac/dc	221 50* 405	Black	£ 56.26
110/120Vac	221 10* 310	Grey	£ 57.28
110/120Vac	221 50* 310	Black	£ 57.28
230/240Vac	221 10* 313	Grey	£ 57.28
230/240Vac	221 50* 313	Black	£ 57.28

SDR LED Rotating light module)

12Vac/dc	231 10* 404	Grey	£ 56.26
12Vac/dc	231 50* 404	Black	£ 56.26
24Vac/dc	231 10* 405	Grey	£ 56.26
24Vac/dc	231 50* 405	Black	£ 56.26
110/120Vac	231 10* 310	Grey	£ 57.28

110/120Vac	231 50* 310	Black	£ 57.28
230/240Vac	231 10* 313	Grey	£ 57.28
230/240Vac	231 50* 313	Black	£ 57.28

SLP Warning light/buzzer combo module

12Vac/dc	250 10* 404	Grey	£ 29.76
12Vac/dc	250 50* 404	Black	£ 29.76
24Vac/dc	250 10* 405	Grey	£ 29.76
24Vac/dc	250 50* 405	Black	£ 29.76
110/120Vac	250 10* 310	Grey	£ 31.80
110/120Vac	250 50* 310	Black	£ 31.80
230/240Vac	250 10* 313	Grey	£ 31.80
230/240Vac	250 50* 313	Black	£ 31.80

SBP Blinking light/buzzer combo module

12Vac/dc	260 10* 404	Grey	£ 40.36
12Vac/dc	260 50* 404	Black	£ 40.36
24Vac/dc	260 10* 405	Grey	£ 40.36
24Vac/dc	260 50* 405	Black	£ 40.36
110/120Vac	260 10* 310	Grey	£ 42.40
110/120Vac	260 50* 310	Black	£ 42.40
230/240Vac	260 10* 313	Grey	£ 42.40
230/240Vac	260 50* 313	Black	£ 42.40

SFP Flashing light/buzzer combo module

12Vac/dc	270 10* 404	Grey	£ 67.37
12Vac/dc	270 50* 404	Black	£ 67.37
24Vac/dc	270 10* 405	Grey	£ 67.37
24Vac/dc	270 50* 405	Black	£ 67.37
110/120Vac	270 10* 310	Grey	£ 64.62
110/120Vac	270 50* 310	Black	£ 64.62
230/240Vac	270 10* 313	Grey	£ 64.62
230/240Vac	270 50* 313	Black	£ 64.62

SCP LED Warning light/buzzer combo module

12Vac/dc	251 10* 404	Grey	£ 67.88
12Vac/dc	251 50* 404	Black	£ 67.88
24Vac/dc	251 10* 405	Grey	£ 67.88
24Vac/dc	251 50* 405	Black	£ 67.88
110/120Vac	251 10* 310	Grey	£ 68.90
110/120Vac	251 50* 310	Black	£ 68.90
230/240Vac	251 10* 313	Grey	£ 68.90
230/240Vac	251 50* 313	Black	£ 68.90

SAP LED Blinking light/buzzer combo module

12Vac/dc	261 10* 404	Grey	£ 68.90
12Vac/dc	261 50* 404	Black	£ 68.90
24Vac/dc	261 10* 405	Grey	£ 68.90
24Vac/dc	261 50* 405	Black	£ 68.90
110/120Vac	261 10* 310	Grey	£ 69.92
110/120Vac	261 50* 310	Black	£ 69.92
230/240Vac	261 10* 313	Grey	£ 69.92

	230/240Vac	261 50* 313	Black	£ 69.92
SRP LED Rotating light/buzzer combo module				
	12Vac/dc	271 10* 404	Grey	£ 68.90
	12Vac/dc	271 50* 404	Black	£ 68.90
	24Vac/dc	271 10* 405	Grey	£ 68.90
	24Vac/dc	271 50* 405	Black	£ 68.90
	110/120Vac	271 10* 310	Grey	£ 69.92
	110/120Vac	271 50* 310	Black	£ 69.92
	230/240Vac	271 10* 313	Grey	£ 69.92
	230/240Vac	271 50* 313	Black	£ 69.92
SPE Buzzer module (1 tone) NEW!!				
	12Vac/dc	243 100 404	Grey	£ 20.38
	12Vac/dc	243 500 404	Black	£ 20.38
	24Vac/dc	243 100 405	Grey	£ 20.38
	24Vac/dc	243 500 405	Black	£ 20.38
	110/120Vac	243 100 310	Grey	£ 21.40
	110/120Vac	243 500 310	Black	£ 21.40
	230/240Vac	243 100 313	Grey	£ 21.40
	230/240Vac	243 500 313	Black	£ 21.40
SPZ Buzzer module (2 tone) NEW!!				
	12Vac/dc	244 100 404	Grey	£ 22.42
	12Vac/dc	244 500 404	Black	£ 22.42
	24Vac/dc	244 100 405	Grey	£ 22.42
	24Vac/dc	244 500 405	Black	£ 22.42
	110/120Vac	244 100 310	Grey	£ 23.44
	110/120Vac	244 500 310	Black	£ 23.44
	230/240Vac	244 100 313	Grey	£ 23.44
	230/240Vac	244 500 313	Black	£ 23.44
STE Sound generator, single tone				
	12-24Vac/dc	241 100 405	Grey	£ 74.40
	12-24Vac/dc	241 500 405	Black	£ 74.40
	110-230Vac (40/60Hz)	241 100 313	Grey	£ 75.42
	110-230Vac (40/60Hz)	241 500 313	Black	£ 75.42
STZ Sound generator, two tone				
	12-24Vac/dc	242 100 405	Grey	£ 77.46
	12-24Vac/dc	242 500 405	Black	£ 77.46
	110-230Vac (40/60Hz)	242 100 313	Grey	£ 78.48
	110-230Vac (40/60Hz)	242 500 313	Black	£ 78.48
BMW Basic module for horizontal mounting				
		200 100 900	Grey	£ 15.80
		200 500 900	Black	£ 15.80
	Basic module + right angle bracket	200 600 900	Black	£ 19.37
	Basic module + 10cm tube sub-assembly	200 700 900	Black	£ 20.89
	Basic module + 25cm tube sub-assembly	200 800 900	Black	£ 23.44
	Basic module + 40cm tube sub-assembly	200 940 900	Black	£ 29.56
	Basic module + 50cm tube sub-assembly	200 950 900	Black	£ 33.63
	Basic module + 60cm tube sub-assembly	200 960 900	Black	£ 37.71

Basic module + 80cm tube sub-assembly	200 980 900	Black	£ 49.43
(Above includes a DI2 sealing gasket for pole b; extra tube length /cm			£ 0.17
DI1 Lens sealing gasket (IP65) pack of 6			
	204 0E0 003		£ 2.45
DI2 Mounting gasket (IP65) pack of 3			
	204 0E0 004		£ 3.06
BA15d Lamps			
GL12	890 010 904	12V/7W	£ 2.35
GL24	890 010 905	24V/7W	£ 2.35
GL48	890 010 908	48V/7W	£ 2.35
GL60	890 010 909	60V/7W	£ 2.35
GL11	890 010 910	110V/7W	£ 2.35
GL23	890 010 913	230V/7W	£ 2.35
Base for tube mounting (black)	201 600 900		£ 15.90
Pole foot (black)	205 500 900		£ 1.22
Flat gasket for top of tube	207 400 900		£ 0.61
Rubber O-ring for bottom of tube	207 500 900		£ 0.61
Flat gasket for under foot	207 600 900		£ 1.02
Insulation liner for tube (10cm)	204 210 901		£ 0.51
Insulation liner for tube (25cm)	204 225 901		£ 1.12
Insulation liner for tube (40cm)	204 240 901		£ 1.63
Aluminium tube (10cm)	204 210 900		£ 1.63
Aluminium tube (25cm)	204 225 900		£ 3.67
Aluminium tube (40cm)	204 240 900		£ 4.99
Cap (black)	202 600 900		£ 1.22

*** Key**

1 = ORANGE : 2 = RED : 4 = CLEAR : 5 = BLUE : 6 = GREEN : 7 = YELLOW

AUER

Price List 2001

Acoustic signals

Mini Hooter KLH1

6-8Vac	710 100 103	£20.09
12Vac	710 100 104	£20.09
24Vac	710 100 105	£20.09
42Vac	710 100 107	£20.09
48Vac	710 100 108	£20.09
60Vac	710 100 109	£20.09
110Vac	710 100 110	£20.09
230vac	710 100 113	£20.09

Mini Hooter KLH2

6Vdc	710 100 003	£21.79
12Vdc	710 100 004	£21.79
24Vdc	710 100 005	£21.79
48Vdc	710 100 008	£21.79
60Vdc	710 100 009	£21.79
110Vdc	710 100 010	£21.79
220Vdc	710 100 013	£21.79

Mini Hooter KDH1

6-8Vac	710 000 103	£19.69
12Vac	710 000 104	£19.69
24Vac	710 000 105	£19.69
42Vac	710 000 107	£19.69
48Vac	710 000 108	£19.69
60Vac	710 000 109	£19.69
110Vac	710 000 110	£19.69
230vac	710 000 113	£19.69

Mini Hooter KDH2

6Vdc	710 000 003	£21.39
12Vdc	710 000 004	£21.39
24Vdc	710 000 005	£21.39
48Vdc	710 000 008	£21.39
60Vdc	710 000 009	£21.39
110Vdc	710 000 010	£21.39
220Vdc	710 000 013	£21.39

Medium Signal Horn HMK1

6Vac	711 000 103	£28.09
12Vac	711 000 104	£28.09
24Vac	711 000 105	£28.09
42Vac	711 000 107	£28.09
48Vac	711 000 108	£28.09

	60Vac	711 000 109	£28.09
	110Vac	711 000 110	£28.09
	230vac	711 000 113	£28.09
Medium Signal Horn HMK2			
	6Vdc	711 000 003	£32.58
	12Vdc	711 000 004	£32.58
	24Vdc	711 000 005	£32.58
	48Vdc	711 000 008	£32.58
	60Vdc	711 000 009	£32.58
	110Vdc	711 000 010	£32.58
	220Vdc	711 000 013	£32.58
Indoor Hooter IPT1			
	6Vac	100 001 221	£61.17
	12Vac	100 001 222	£61.17
	24Vac	100 001 223	£61.17
	48Vac	100 001 224	£61.17
	60Vac	100 001 225	£61.17
	110Vac	100 001 226	£61.17
	230V+B94ac	100 001 226	£61.17
Indoor Hooter IPT2			
	6Vdc	100 001 231	£79.06
	12Vdc	100 001 232	£79.06
	24Vdc	100 001 233	£79.06
	48Vdc	100 001 234	£79.06
	60Vdc	100 001 235	£79.06
	110Vdc	100 001 236	£79.06
	220Vdc	100 001 237	£79.06
Insert Hooter EPT1			
	6Vac	100 101 221	£51.37
	12Vac	100 101 222	£51.37
	24Vac	100 101 223	£51.37
	48Vac	100 101 224	£51.37
	60Vac	100 101 225	£51.37
	110Vac	100 101 226	£51.37
	230Vac	100 101 227	£51.37
Insert Hooter EPT2			
	6Vdc	100 101 231	£59.87
	12Vdc	100 101 232	£59.87
	24Vdc	100 101 233	£59.87
	48Vdc	100 101 234	£59.87
	60Vdc	100 101 235	£59.87
	110Vdc	100 101 236	£59.87

	220Vdc	100 101 237	£59.87
Signal Horn HPT1			
	6Vac	712 100 103	£60.77
	12Vac	712 100 104	£60.77
	24Vac	712 100 105	£60.77
	42Vac	712 100 107	£60.77
	48Vac	712 100 108	£60.77
	60Vac	712 100 109	£60.77
	110Vac	712 100 110	£60.77
	230Vac	712 100 113	£60.77
	110Vac (60Hz)	712 100 211	£60.77
	230Vac (60Hz)	712 100 213	£60.77
Signal Horn HPT2			
	6Vdc	712 100 003	£75.96
	12Vdc	712 100 004	£75.96
	24Vdc	712 100 005	£75.96
	48Vdc	712 100 008	£75.96
	60Vdc	712 100 009	£75.96
	110Vdc	712 100 010	£75.96
	220Vdc	712 100 013	£75.96
Signal Horn HPTR1 (with telephone relay)			
	230Vac (50Hz)	712 102 113	£130.53
	240Vac (60Hz)	712 102 213	£130.53
Signal Horn HPTR2 (with telephone relay)			
	220Vdc	712 102 013	£145.53
Industrial Hooter HTG1			
	6Vac	713 100 103	£123.24
	12Vac	713 100 104	£123.24
	24Vac	713 100 105	£123.24
	42Vac	713 100 107	£123.24
	48Vac	713 100 108	£123.24
	60Vac	713 100 109	£123.24
	110Vac	713 100 110	£123.24
	230Vac	713 100 113	£123.24
	110Vac (60Hz)	713 100 211	£123.24
	240Vac (60Hz)	713 100 213	£123.24
Industrial Hooter HTG2			
	6Vdc	713 100 003	£138.63
	12Vdc	713 100 004	£138.63
	24Vdc	713 100 005	£138.63
	48Vdc	713 100 008	£138.63

	12Vdc	720 000 004	£97.15
	24Vdc	720 000 005	£97.15
	48Vdc	720 000 008	£97.15
	60Vdc	720 000 009	£97.15
	110Vdc	720 000 010	£97.15
	220Vdc	720 000 013	£97.15
Bell FWS1 (red)			
	12Vac	720 000 104	£88.45
	24Vac	720 000 105	£88.45
	42Vac	720 000 107	£88.45
	48Vac	720 000 108	£88.45
	60Vac	720 000 109	£88.45
	110Vac	720 000 110	£88.45
	230Vac	720 000 113	£88.45
Bell FWS2 (red)			
	12Vdc	720 000 004	£97.15
	24Vdc	720 000 005	£97.15
	48Vdc	720 000 008	£97.15
	60Vdc	720 000 009	£97.15
	110Vdc	720 000 010	£97.15
	220Vdc	720 000 013	£97.15
Bell FWSR1 (red with telephone relay)			
	220Vac	720 220 013	£146.93
Bell UWSR1 (grey with telephone relay)			
	220Vac	720 100 013	£146.93
Electronic Sound Generator EHG11 (swivel)			
	110Vac (40-60Hz)	731 000 110	£244.58
	230Vac (40-60Hz)	731 000 113	£244.58
Electronic Sound Generator EHG12 (swivel)			
	12Vac/dc	731 000 004	£223.19
	24Vac/dc	731 000 005	£223.19
Electronic Sound Generator EHG21 (fixed)			
	110Vac (40-60Hz)	731 100 110	£240.18
	230Vac (40-60Hz)	731 100 113	£240.18
Electronic Sound Generator EHG22 (fixed)			
	12Vac/dc	731 100 004	£218.79
	24Vac/dc	731 100 005	£218.79
Electronic Sound Generator EHL1			

	110Vac (40-60Hz)	730 000 110	£204.80
	230Vac (40-60Hz)	730 000 113	£204.80
Electronic Sound Generator EHL2			
	12Vac/dc	730 000 004	£191.80
	24Vac/dc	730 000 005	£191.80
Motor Siren SE1			
	12Vac/dc	593 003 002	£294.85
	24Vac/dc	593 003 003	£294.85
	110Vac/dc	593 004 008	£294.85
	230Vac/dc	593 004 009	£280.76
	Hood	594 001 000	£32.68
Motor Siren SE2			
	24Vac/dc	593 005 003	£471.36
	110Vac/dc	593 006 008	£471.36
	230Vac/dc	593 006 009	£448.87
	Hood	594 001 000	£32.68
Motor Siren SE3			
	110Vac/dc	593 009 008	£939.72
	230Vac/dc	593 009 009	£894.94
	Hood	594 003 000	£116.44
Crank operated Siren HSM7			
		573 001 000	£996.39
Pull controlled Siren HZ 1			
		573 030 008	£321.64

AUER

Price List 2001

"Ex" Products

Signal Horn dHG1

6Vac	321 266 501	£312.09
12Vac	321 266 502	£312.09
24Vac	321 266 503	£312.09
42Vac	321 266 504	£312.09
48Vac	321 266 510	£312.09
60Vac	321 266 505	£312.09
110Vac	321 266 506	£312.09
230Vac	321 266 507	£312.09
120Vac (60Hz)	321 266 526	£325.45
240Vac (60Hz)	321 266 527	£325.45

Signal Horn dHG2

.	321 266 511	£325.45
12Vdc	321 266 512	£325.45
24Vdc	321 266 513	£325.45
48Vdc	321 266 514	£325.45
60Vdc	321 266 515	£325.45
110Vdc	321 266 516	£325.45
220Vdc	321 266 517	£325.45

Signal Horn dHGR1 (with telephone relay)

230Vac (50Hz)	321 266 537	£449.79
---------------	-------------	---------

Signal Horn dHGR2 (with telephone relay)

220Vdc	321 266 557	£449.79
--------	-------------	---------

Signal Bell dWG1

6Vac	321 162 501	£319.90
12Vac	321 162 502	£319.90
24Vac	321 162 503	£319.90
42Vac	321 162 504	£319.90
48Vac	321 162 510	£319.90
60Vac	321 162 505	£319.90
110Vac	321 162 506	£319.90
230Vac	321 162 507	£319.90
120Vac (60Hz)	321 162 526	£336.32
240Vac (60Hz)	321 162 527	£336.32

Signal Bell dWG2

6Vdc	321 162 511	£336.32
12Vdc	321 162 512	£336.32
24Vdc	321 162 513	£336.32
48Vdc	321 162 514	£336.32

60Vdc	321 162 515	£336.32
110Vdc	321 162 516	£336.32
220Vdc	321 162 517	£336.32
Signal Bell dWGR1 (with telephone relay)		
230Vac (50Hz)	321 162 537	£461.68
Signal Bell dWGR2 (with telephone relay)		
220Vdc	321 162 557	£477.87
Flashing Beacon dBZ1 (5 Joule)		
110Vac (50/60Hz)	333 01* 110	£684.87
230Vac (50/60Hz)	333 01* 113	£641.50
Flashing Beacon dBZ2 (5 Joule)		
12Vdc	333 02* 004	£684.87
24Vdc	333 02* 005	£684.87
Flashing Beacon dBZ3 (15 Joule)		
110Vac (50/60Hz)	333 03* 110	£703.78
230Vac (50/60Hz)	333 03* 113	£652.71
Flashing Beacon dBZ4 (15 Joule)		
12Vdc	333 04* 004	£698.57
24Vdc	333 04* 005	£698.57

* Key

1 = ORANGE : 2 = RED : 4 = CLEAR : 5 = BLUE : 6 = GREEN : 7 = YELLOW

Rotating Beacon dRZ1		
110Vac (50/60Hz)	333 10* 310	£681.47
120Vac (50/60Hz)	333 10* 312	£681.47
230Vac (50/60Hz)	333 10* 313	£681.47
240Vac (50/60Hz)	333 10* 314	£681.47
Rotating Beacon dRZ2		
12Vdc	333 10* 004	£710.35
24Vdc	333 10* 005	£710.35
110Vdc	333 10* 010	£710.35
Rotating Beacon dRZR1 (with telephone relay)		
230Vac (50/60Hz)	333 12* 313	£833.55

* Key

2 = RED : 4 = CLEAR : 5 = BLUE : 7 = YELLOW

Wall telephone set dWTG11

	400 010 110	£939.09
Wall telephone set dWTG21		
	400 010 120	£939.09
Wall telephone set dWTG22		
	400 010 122	£991.97
Wall telephone set dWTG31		
	400 010 130	£865.71

AUER

Price List 2001

Beacons

WLK Warning beacon (use 7W lamp)

Horizontal fixing	250Vac/dc	820 01* 425	Grey	£8.80
Horizontal fixing	250Vac/dc	820 11* 425	Black	£8.80
Vertical fixing	250Vac/dc	820 02* 425	Grey	£11.59
Vertical fixing	250Vac/dc	820 12* 425	Black	£11.59
Tube fixing	250Vac/dc	820 03* 425	Grey	£8.80
Tube fixing	250Vac/dc	820 13* 425	Black	£8.80
	10cm tube with base	891 010 925	Grey	£3.90
	10cm tube with base	891 110 925	Black	£3.90
	25cm tube with base	891 025 925	Grey	£6.30
	25cm tube with base	891 125 925	Black	£6.30

WLK-DI	cap sealing	820 0E0 003		£0.60
WLK-KAL	cap	820 0E* 001		£5.70
WLK-FAS	socket	820 0E0 002		£3.10
WLK-WI	vertical bracket	820 0E1 004	Grey	£3.50
WLK-WI	vertical bracket	820 0E2 004	Black	£3.50

WLM Warning beacon (use 7W lamp)

Make from component parts of signal towers.

WLG Warning beacon (use 25W lamp)

	250Vac/dc	822 10* 900	Grey	£24.99
	250Vac/dc	822 50* 900	Black	£24.99
WLG-KAL	cap	822 0E* 001		£10.39
WLG-FAS	socket	822 0E0 002		£4.40

WLP Warning beacon/Buzzer combination (use 7W lamp)

Make from component parts of signal towers.

BKM Blinking beacon (use 7W lamp)

Make from component parts of signal towers.

BKG Blinking beacon (use 25W lamp) NEW!!

	12Vac/dc	832 10* 404	Grey	
	12Vac/dc	832 50* 404	Black	
	24Vac/dc	832 10* 405	Grey	
	24Vac/dc	832 50* 405	Black	
	110/120Vac	832 10* 310	Grey	
	110/120Vac	832 50* 310	Black	
	230/240Vac	832 10* 313	Grey	
	230/240Vac	832 50* 313	Black	
WLG-KAL	Lens	822 0E* 001		

BKP Blinking beacon/Buzzer combination (use 7W lamp)

Make from component parts of signal towers.

FLM Flashing beacon (3 Joule)

Make from component parts of signal towers.

FLG Flashing beacon (10 Joule)

(FLG2)	12Vdc	842 14* 004	Grey	£70.46
"	12Vdc	842 54* 004	Black	£70.46
"	24Vdc	842 14* 005	Grey	£70.46
"	24Vdc	842 54* 005	Black	£70.46
(FLG1)	110Vac (50/60Hz)	842 13* 310	Grey	£64.17
"	110Vac (50/60Hz)	842 53* 310	Black	£64.17
"	230Vac (50/60Hz)	842 13* 313	Grey	£64.17
"	230Vac (50/60Hz)	842 53* 313	Black	£64.17
FLG6 Flashing beacon (2 flash frequency 30/60 flash per min)				
	24Vdc	842 16* 005	Grey	£77.46
	24Vdc	842 56* 005	Black	£77.46
FLG6 Flashing beacon (2 flash frequency 30/90 flash per min)				
	24Vdc	842 17* 005	Grey	£77.46
	24Vdc	842 57* 005	Black	£77.46
FLG -KAL	Lens	822 0E* 000		£10.39
FLG-XL10	Xenon tube	842 0E3 000		£19.19

BZL Flashing beacon

BZL1 (5 Joule)	12Vdc	740 01* 404		£94.45
	24Vdc	740 01* 405		£94.45
	110Vac (50/60Hz)	740 01* 110		£97.65
	230Vac (50/60Hz)	740 01* 113		£89.05
BZL2 (5 Joule)	12Vdc	740 02* 004		£91.25
	24Vdc	740 02* 005		£91.25
	110Vac (50/60Hz)	740 03* 110		£125.64
	230Vac (50/60Hz)	740 03* 113		£119.14
BZL4 (15 Joule)	12Vdc	740 04* 004		£142.73
	24Vdc	740 04* 005		£142.73
BZL6 (5 Joule)	24Vdc (30/60 ratio)+	740 16* 005		£103.95
	24Vdc (30/60 ratio)-	740 36* 005		£103.95
	24Vdc (30/90 ratio)+	740 26* 005		£103.95
	24Vdc (30/90 ratio)-	740 46* 005		£103.95
BZL-KAL	Lens	740 0E* 001		£5.80
BZL-XL15	Xenon tube (15 Joule)	740 0E3 000		£19.19
BZL-XL5	Xenon tube (5 Joule)	740 0E1 000		£11.59

BZG Flashing beacon

BZG1 (5 Joule)	12Vdc	741 01* 404		£117.94
----------------	-------	-------------	--	---------

	24Vdc	741 01* 405	£117.94
	110Vac (50/60Hz)	741 01* 110	£120.34
	230Vac (50/60Hz)	741 01* 113	£111.84
BZG2 (5 Joule)	12Vdc	741 02* 004	£114.84
	24Vdc	741 02* 005	£114.84
	110Vac (50/60Hz)	741 03* 110	£149.12
	230Vac (50/60Hz)	741 03* 113	£141.03
BZG4 (15 Joule)	12Vdc	741 04* 004	£165.42
	24Vdc	741 04* 005	£165.42
BZG-KAL1	Lens	740 0E* 001	£5.80
BZG-XL15	Xenon tube (15 Joule)	740 0E3 000	£19.19
BZG-XL5	Xenon tube (5 Joule)	740 0E1 000	£11.59

FLP Flashing beacon/buzzer combination

Make from component parts of signal towers.

880 Rotating mirror beacon (red or yellow)

	12Vdc	988 0*5 254	£154.42
	24Vdc	988 0*5 255	£154.42
	230Vac	988 0*5 268	£176.91
Halogen Lamp (12V)		985 588 034	£10.19
Halogen Lamp (24V)		985 588 035	£10.19
Holder for tube		988 000 000	£32.58

Accessories

BA15d Lamps (7W)

890 010 904	12V	£2.40
890 010 905	24V	£2.40
890 010 908	48V	£2.40
890 010 909	60V	£2.40
890 010 910	110V	£2.40
890 010 913	230V	£2.40

BA15d Lamps (25W)

890 025 904	12V	£2.40
890 025 905	24V	£2.40
890 025 908	48V	£2.40
890 025 909	60V	£2.40
890 025 910	110V	£2.40
890 025 913	230V	£2.40

Xenon tube

740 0E1 000	5 Joule	£11.59
740 0E3 000	15 Joule	£19.19
842 0E3 000	10 Joule	£19.19

Halogen Lamp

985 588 034	12V	£10.19
985 588 035	24V	£10.19

* Key

1 = ORANGE : 2 = RED : 4 = CLEAR : 5 = BLUE : 6 = GREEN : 7 = YELLOW